

Dunkettle Progress Update

07th October 2022



[Twitter](#)



[Website](#)

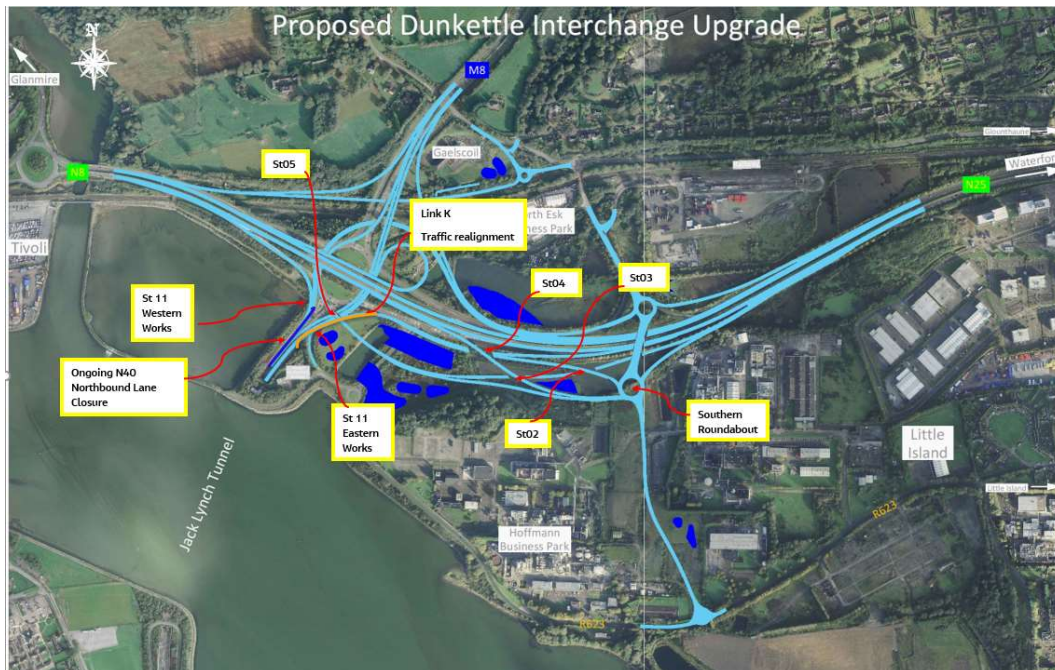

- Motorists are again reminded that speed control measures are in place across the site on a continuous basis over the coming weeks.

- The configuration of the N25 westbound diverge approach (Link K) to the Dunkettle Interchange Roundabout will be adjusted over the coming period. The proposed new alignment in this area is shown on the photo below. There will be a new set of traffic lights in place along the new alignment to cater for this adjustment. The purpose of the adjustment in this area is to facilitate access for ground improvement works in the area immediately west of Structure St05.

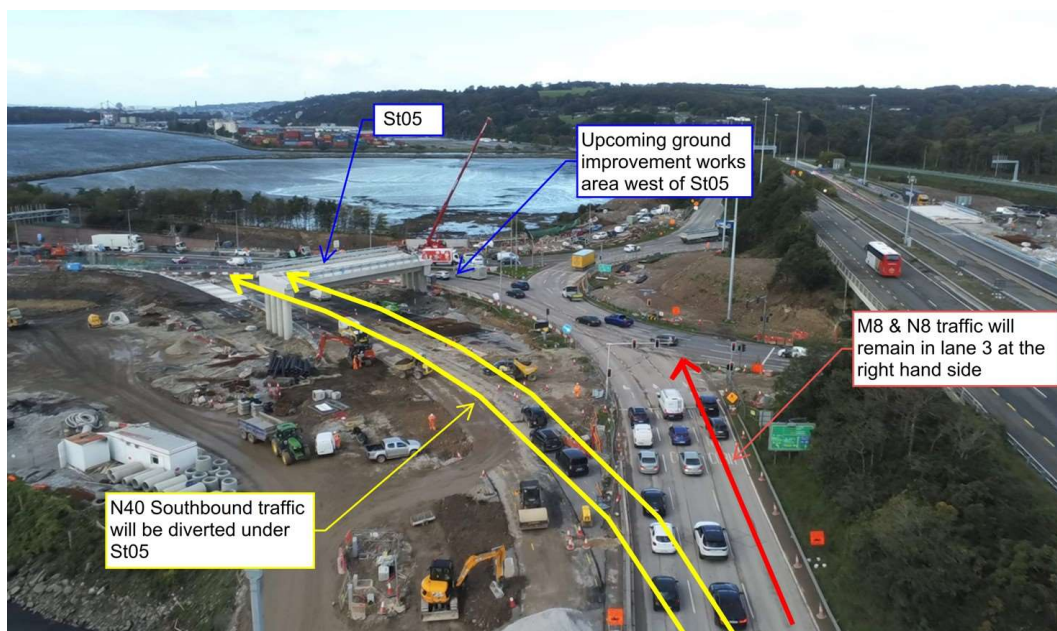

Upcoming traffic realignment on the N25 westbound diverge approach to the Dunkettle Interchange Roundabout.

- Traffic Management measures remain in place on the northbound lanes between the Jack Lynch Tunnel and the Interchange Roundabout. The works to construct the new retaining wall are continuing – see photograph below. These works are adding to delays at peak times and the works will continue over the coming weekend with a view to minimising this disruption. The scope of the

Traffic Management measures is being reduced as the works are progressed and we hope that these Traffic Management arrangements will be substantially removed by Friday 21st October 2022.

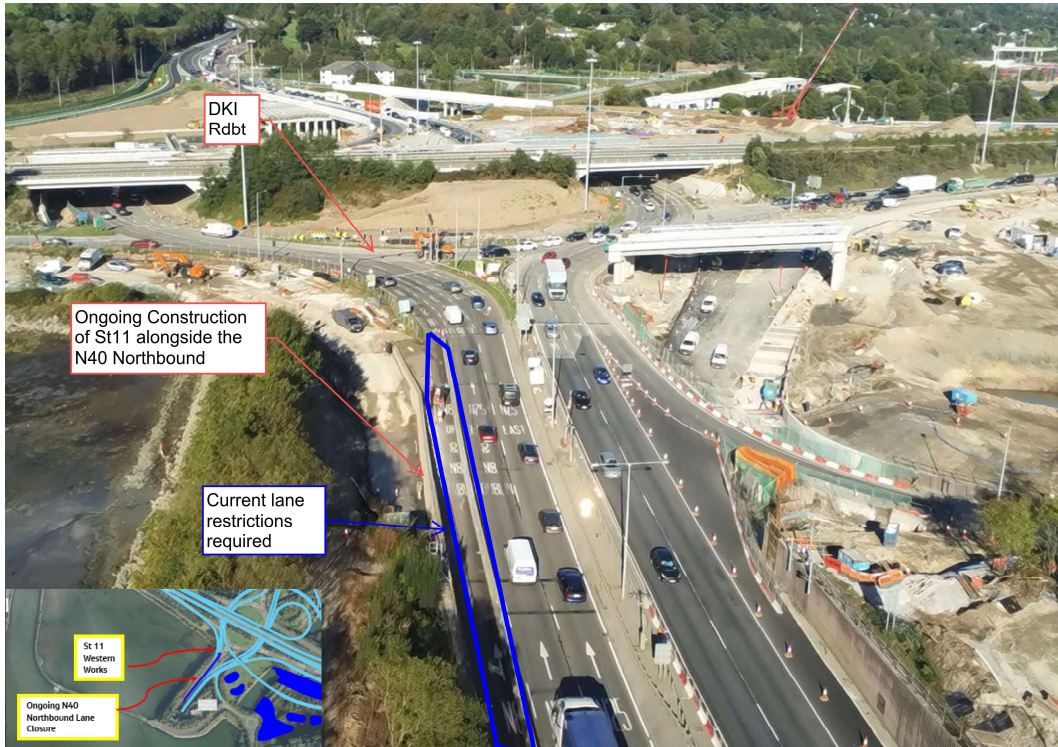

Ongoing works on the N40 northbound approach to the Dunkettle Interchange Roundabout.

- In relation to Bridge Structures, works are continuing at Structures St02, St03 & St04 alongside the N25 westbound – see photograph below.



Works continuing at Structures St02, St03 & St04 alongside the N25 westbound.

- The recently constructed roundabout on the R623 access to Little Island from the N40 will be closed from 19:00 tonight Friday 7th October until 18:00 tomorrow Saturday 8th October 2022. Traffic will be diverted via the Little Island Flyover and the N25 in both directions. These works are required in order to tie into the new Link Road Q – see photograph below.

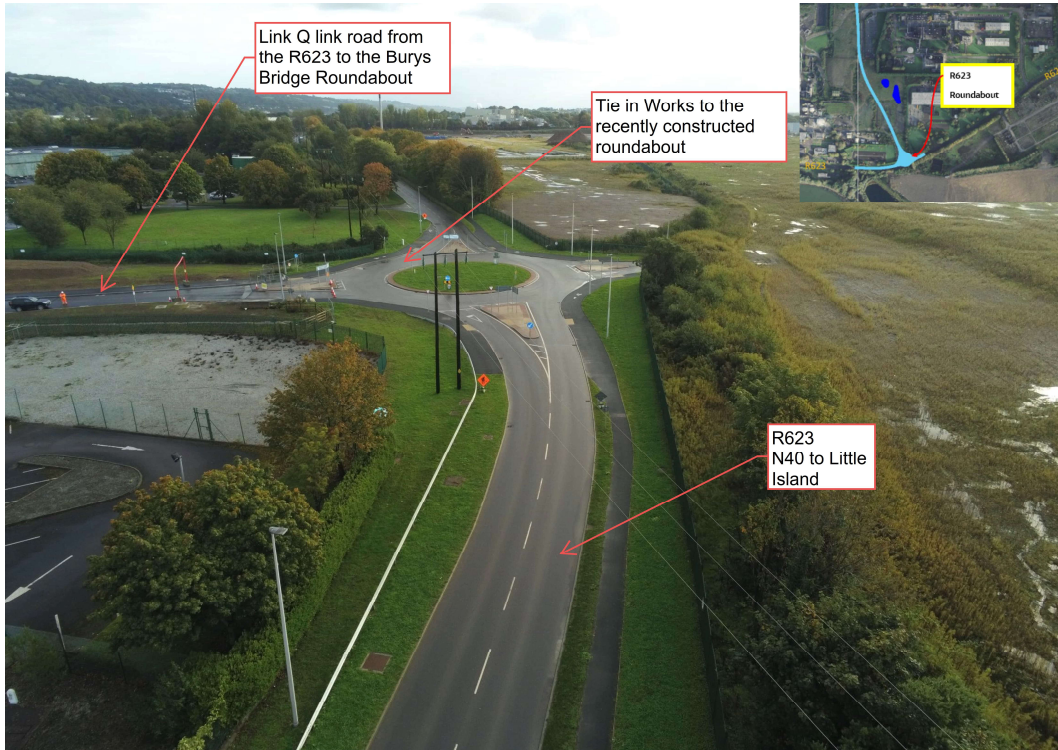

Pavement works area on the R623 Little Island access from the N40 southbound

- Motorists are requested to take particular care over the coming months while layout changes are implemented at various locations. The construction focus overall will continue to be on online areas and areas immediately adjacent to existing traffic lanes.

This week's video shows the approach to the Dunkettle Interchange Roundabout from the N25 Westbound where traffic heading Southbound through the Jack Lynch Tunnel will be reconfigured over the coming period



Dunkettle Live Traffic App

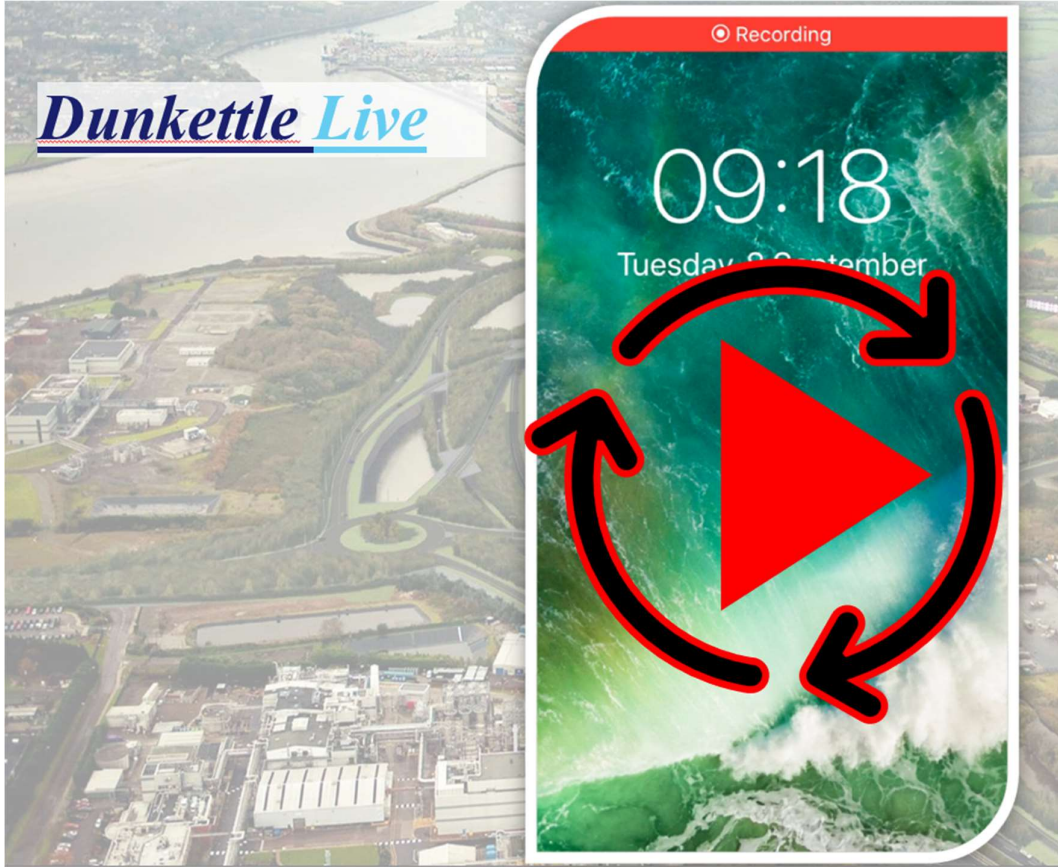

Click on the icon above to see the benefits of the Dunkettle Live App.



Dunkettle Live App: Download from [Apple App store](#) or from [Google Play store](#)



As always, if there are any queries or comments in relation to these works, please contact us at:

Phone: 1800 810077 (at any time), **Email:** roadconstruction@ccc-site.com.

Further information on the Dunkettle Scheme can be accessed www.dunkettle.ie.

Real time traffic information can be accessed via www.dunkettletraffic.ie or on the Dunkettle Live App ([Apple App store](#) and [Google Play store](#)).

New subscribers to the newsletter can register: www.dunkettle.ie/newslettersignup



[More at www.Dunkettle.ie](http://www.Dunkettle.ie)



Your email address is on a list that we use to keep you informed on the progress on the N40 and Dunkettle Interchange works.

Want to change how you receive these emails?

You can [update your preferences](#) or [unsubscribe from this list](#).
